

E-41 Pressure Regulating Valve

DESCRIPTION

The Cash Acme E-41 Pressure Reducing and Regulating Valve automatically reduces a high inlet pressure to a lower delivery pressure and maintains the lower pressure within acceptable limits.

The Cash Acme E-41 Regulator provides high capacity and close regulation for more demanding and higher quality installations.

The **Cash Acme E-41 Regulator** is available in 1/2" through 2" sizes. The **E-41** is suitable for installation in domestic water supply lines (after the meter) in systems where inlet pressures do not exceed 300 psi or where system temperatures do not exceed 180° F. The valves are supplied with a standard delivery setting of 45 psi and have threaded female inlet and outlet connections.

Cash Acme's **E-41 Pressure Reducing and Regulating Valve** is similar in internal design to the **E-3** regulator with the exception that it is not fitted with an inbuilt strainer for systems which do not require the feature, or where separate, individual strainers are preferred.

FEATURES AND BENEFITS

Automatically reduces a high inlet pressure to a lower delivery pressure:
Maintains a lower pressure within reasonably close limits.

Every valve is tested through a range of tests prior to shipping:
Specify and install with confidence!

High capacities for higher quality installations:
Handles more volume with just one regulator.

Listed by ASSE 1003, CSA and IAPMO:
Inspector friendly, peace of mind!

SPECIFICATION

A pressure reducing valve shall be installed to deliver water at a controlled pressure. The valve shall be ASSE 1003 and IAPMO listed. The valve shall be a bronze body with a maximum inlet pressure of 300 psi. The valve shall be a yoke-type design with a buna seat disc and a stainless steel body seat. The valve shall be a **Cash Acme E-41 Pressure Regulator**.

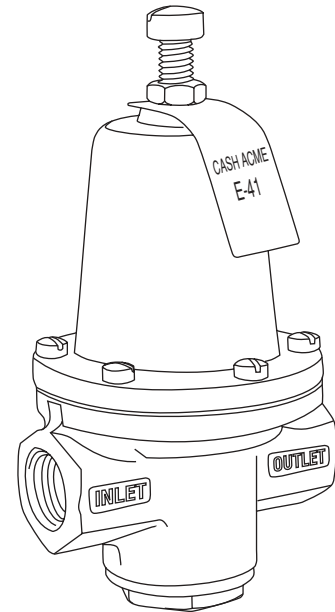

E-41 Pressure Regulating Valve

TYPICAL INSTALLATION

The E-41 pressure regulator should be installed in the horizontal position with the spring chamber upright. For other installation requirements, consult the factory.

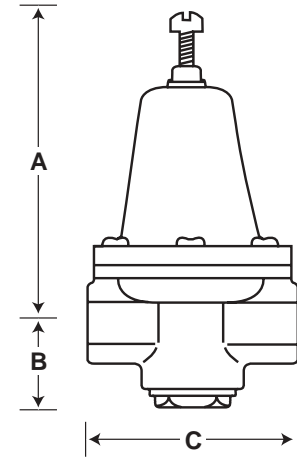
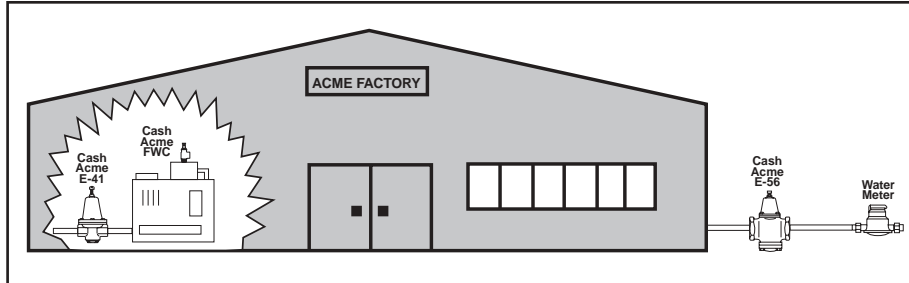

SPECIFICATION DATA

Performance:

- Outlet pressure range 20-70 psi (45 psi standard)
- Maximum temperature 180° F
- Maximum inlet pressure 300 psi
- Service Water

Materials:

- Body Bronze
- Seals Steel (zinc plated)
- Adjustment Springs Steel (zinc plated)

CONNECTIONS (sold separately)

Threaded (NPT) 1/2", 3/4", 1", 1 1/4", 1 1/2" and 2"

Size	Spring Number an Adj Range (in psi)			Piston Spring
1/2"	#10364 - 10-40	#10364 - 20-70	#10638 - 71-150	#11273
3/4"	#11285 - 10-40	#11320 - 20-70	#10640 - 71-150	#11277
1"	#10558 - 10-40	#10558 - 20-70	#10645 - 71-150	#11278
1 1/4"	#10558 - 10-40	#10558 - 20-70	#10642 - 71-150	#11282
1 1/2"	#10641 - 10-40	#10641 - 20-70	#10643 - 71-150	#11283
2"	#10683 - 10-40	#10683 - 20-70	#10685 - 71-150	#11284

Dimensions	A	B	C
1/2"	3 3/8"	5 1/4"	1 1/2"
3/4"	4 1/16"	5 15/16"	1 7/8"
1"	4 9/16"	7"	2 5/16"
1 1/4"	5 3/16"	7 1/2"	2 3/8"
1 1/2"	5 13/16"	8 1/2"	2 5/8"
2"	6 1/2"	10 1/4"	2 3/4"

Cash Acme E-41 Water Capacity (gpm)

Pipe Size	P ₂ VAR. (psi)	Differential Pressure P ₁ -P ₂ (psi)			
		10	25	50	100 Or More
1/2"	5	3	4	4 1/2	5 1/2
	10	6	8	10	11
	15	8	11	13 1/2	15
	20	9 1/2	13	15 1/2	17
3/4"	5	4	6 1/2	7 1/2	9
	10	8 1/2	12 1/2	16	17
	15	12 1/2	17 1/2	22	24
	20	15 1/2	21	26	28
1"	5	7	10	11	12
	10	15	20 1/2	25 1/2	27 1/2
	15	22	29	35 1/2	37 1/2
	20	28	35	41 1/2	44 1/2
1 1/4"	5	8 1/2	11	12	14
	10	20	27	33	36
	15	30	41	51	55
	20	40	53	65	70
1 1/2"	5	10 1/2	14	16	18
	10	27	38	48	52
	15	39	55	70	76
	20	50	72	92	100
2"	5	16	20	23	25
	10	37	52	65	70
	15	55	76	95	102
	20	70	97	120	130

*Note 10-40 psi range requires the addition of a Piston Spring in table above.